

## 8. 不断水T字管

### 不断水T字管 コスモバルブST型(分岐口径φ40・50) (通水部粉体塗装)

コスモ工機(株)

| 呼び径    | 内ねじ式・外ねじ式             |                        |                        |                     | フランジ式             |                    |                    |                 |
|--------|-----------------------|------------------------|------------------------|---------------------|-------------------|--------------------|--------------------|-----------------|
|        | 鋳鉄管用                  | 鋳鉄管用                   | 塩ビ・鋼管                  | 配水ホリ用               | 鋳鉄管用              | 鋳鉄管用               | 塩ビ・鋼管              | 配水ホリ用           |
|        | STCP(N・U)SP<br>全周パッキン | STC(N・U)2SP<br>分岐部パッキン | STV(N・U)2SP<br>分岐部パッキン | STPPN(UN)<br>全周パッキン | STCPFSP<br>全周パッキン | STCF2SP<br>分岐部パッキン | STVF2SP<br>分岐部パッキン | STPPF<br>全周パッキン |
| 50X40  |                       |                        | 49,320 注1              | 75,030 注2           |                   |                    |                    |                 |
| 50X50  |                       |                        | 50,890 注1              | 79,610 注2           |                   |                    | 54,450 注1          | 80,910 注2       |
| 75X40  | 50,460                | 48,980                 | 48,980                 | 75,680 注2           |                   |                    |                    |                 |
| 75X50  | 54,270                | 52,700                 | 52,700                 | 81,430 注2           | 56,360            | 54,730             | 54,730             | 84,560 注2       |
| 100X40 | 54,670                | 53,080                 | 53,080                 | 82,010 注2           |                   |                    |                    |                 |
| 100X50 | 58,050                | 56,360                 | 56,360                 | 87,070 注2           | 63,990            | 62,100             | 62,100             | 95,980 注2       |
| 125X40 |                       |                        | 57,990                 |                     |                   |                    |                    |                 |
| 125X50 |                       |                        | 60,480                 |                     |                   |                    | 65,930             |                 |
| 150X40 | 64,260                | 62,380                 | 62,380                 | 96,400 注2           |                   |                    |                    |                 |
| 150X50 | 67,460                | 65,490                 | 65,490                 | 101,210 注2          | 72,700            | 70,590             | 70,590             | 109,030 注2      |
| 200X40 | 82,010                | 79,620                 | 79,620                 | お問い合わせ下さい           |                   |                    |                    |                 |
| 200X50 | 85,420                | 82,910                 | 82,910                 | お問い合わせ下さい           | 90,990            | 88,390             | 88,390             | お問い合わせ下さい       |
|        |                       | STCD(N・U)SP<br>分岐部パッキン |                        |                     |                   | STCDFSP<br>分岐部パッキン | STVFSP<br>分岐部パッキン  |                 |
| 250X40 | 96,230                | 97,090                 | 116,060 注3             |                     |                   |                    |                    |                 |
| 250X50 | 99,310                | 99,630                 | 139,330 注3             |                     | 105,220           | 106,650            | 144,240 注3         |                 |
| 300X40 | 108,800               | 109,700                | 134,650 注3             |                     |                   |                    |                    |                 |
| 300X50 | 109,440               | 110,300                | 160,680 注3             |                     | 115,200           | 118,720            | 166,020 注3         |                 |
| 350X40 | 115,300               | 118,990                | 137,720 注3             |                     |                   |                    |                    |                 |
| 350X50 | 118,330               | 119,560                | 163,600 注3             |                     | 123,980           | 126,010            | 168,980 注3         |                 |
| 400X40 | 165,650               | 151,530                | 140,160 注3             |                     |                   |                    |                    |                 |
| 400X50 | 170,020               | 154,410                | 166,490 注3             |                     | 175,070           | 158,820            | 171,860 注3         |                 |
|        |                       |                        |                        |                     |                   | STCFSP<br>分岐部パッキン  |                    |                 |
| 450X40 | 377,190               | 154,230                | 154,230 注3             |                     |                   |                    |                    |                 |
| 450X50 | 381,840               | 174,500                | 174,500 注3             |                     | 388,030           | 179,880 注3         | 179,880 注3         |                 |
| 500X40 | 486,270               | 159,270                | 159,270 注3             |                     |                   |                    |                    |                 |
| 500X50 | 490,960               | 181,870                | 181,870 注3             |                     | 496,330           | 187,240 注3         | 187,240 注3         |                 |
| 600X40 | 570,240               | 178,180                | 175,180 注3             |                     |                   |                    |                    |                 |
| 600X50 | 576,020               | 203,100                | 203,100 注3             |                     | 580,370           | 208,530 注3         | 208,530 注3         |                 |
| 700X40 |                       | 178,750                | 178,750 注3             |                     |                   |                    |                    |                 |
| 700X50 |                       | 210,820                | 210,820 注3             |                     |                   | 216,170 注3         | 216,170 注3         |                 |

注1 鋳鉄管にも使用可能です

注2 穿孔工事が特殊な為、事前にお問合せ願います

注3 ニツ割鋼板製、分岐部パッキンになります

※石綿管用は都度お問合せ願います

# 不断水T字管

## コスモバルブST型(分岐口径φ40・50) (通水部粉体塗装)

鹿児島市型  
SUSボルトナット使用

コスモ工機(株)

| 呼び径    | 内ねじ式・外ねじ式         |                    |                       |                     | フランジ式             |                    |                    |                 |
|--------|-------------------|--------------------|-----------------------|---------------------|-------------------|--------------------|--------------------|-----------------|
|        | 鋳鉄管用              | 鋳鉄管用               | 塩ビ・鋼管                 | 配水ポリ用               | 鋳鉄管用              | 鋳鉄管用               | 塩ビ・鋼管              | 配水ポリ用           |
|        | STCPNSP<br>全周パッキン | STCN2SP<br>分岐部パッキン | STV(S)N2SP<br>分岐部パッキン | STPPN(UN)<br>全周パッキン | STCPFSP<br>全周パッキン | STCF2SP<br>分岐パッキン  | STVF2SP<br>分岐部パッキン | STPPF<br>全周パッキン |
| 50X40  |                   | 62,840             | 54,480 注1             | 86,930 注2           |                   |                    |                    |                 |
| 50X50  |                   | 64,750             | 56,050 注1             | 91,510 注2           |                   | 68,270             | 59,610 注1          | 92,810 注2       |
| 75X40  | 56,260            | 54,780             | 55,100                | 87,380 注2           |                   |                    |                    |                 |
| 75X50  | 60,070            | 58,500             | 58,850                | 93,130 注2           | 62,160            | 60,530             | 60,850             | 96,260 注2       |
| 100X40 | 60,470            | 59,280             | 59,200                | 93,710 注2           |                   |                    |                    |                 |
| 100X50 | 63,850            | 62,560             | 6,280                 | 98,770 注2           | 69,790            | 68,300             | 68,220             | 107,680 注2      |
| 125X40 |                   |                    | 64,110                |                     |                   |                    |                    |                 |
| 125X50 |                   |                    | 66,600                |                     |                   |                    | 72,050             |                 |
| 150X40 | 70,060            | 68,460             | 68,500                | 108,100 注2          |                   |                    |                    |                 |
| 150X50 | 73,260            | 71,570             | 71,610                | 112,910 注2          | 78,500            | 76,670             | 76,710             | 120,730 注2      |
| 200X40 | 90,370            | 87,980             | 87,980                |                     |                   |                    |                    |                 |
| 200X50 | 93,780            | 91,270             | 91,270                |                     | 99,350            | 96,750             | 96,750             |                 |
|        |                   | STCDNSP<br>分岐部パッキン |                       |                     |                   | STCDNSP<br>分岐部パッキン |                    |                 |
| 250X40 | 108,890           | 116,080            |                       |                     |                   |                    |                    |                 |
| 250X50 | 111,970           | 118,620            |                       |                     | 117,880           | 125,640            |                    |                 |
| 300X40 | 121,460           | 128,690            |                       |                     |                   |                    |                    |                 |
| 300X50 | 122,100           | 129,290            |                       |                     | 127,860           | 13,770             |                    |                 |
| 350X40 | 138,700           | 137,980            |                       |                     |                   |                    |                    |                 |
| 350X50 | 141,730           | 138,550            |                       |                     | 141,380           | 145,000            |                    |                 |
| 400X40 | 189,005           | 170,520            |                       |                     |                   |                    |                    |                 |
| 400X50 | 193,420           | 173,400            |                       |                     | 198,470           | 177,810            |                    |                 |

注1 鋳鉄管にも使用可能です

注2 穿孔工事が特殊な為、事前にお問合せ願います

※石綿管は都度お問合せ願います

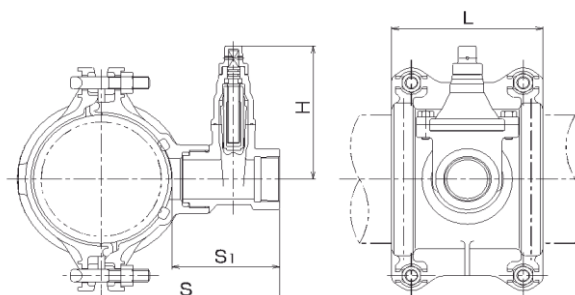

※下記は鋳鉄管用の寸法になります

| 呼び径    | S     | S1  | L        | H   | T頭ボルト・ナット |
|--------|-------|-----|----------|-----|-----------|
| 75x40  | 185.5 | 136 | 154      | 156 | 4-M16x85  |
| 100x40 | 198.0 |     | 156      |     | 4-M16x85  |
| 150x40 | 224.0 |     | 190      |     | 4-M16x85  |
| 200x40 | 249.5 |     | 220      |     | 4-M20x90  |
| 75x50  | 185.5 |     | 154      |     | 176       |
| 100x50 | 198.0 | 156 | 4-M16x85 |     |           |
| 150x50 | 224.0 | 190 | 4-M16x85 |     |           |
| 200x50 | 249.5 | 220 | 4-M20x90 |     |           |



# 不断水T字管

## コスモバルブSTソフト型(分岐口径φ75以上) (通水部粉体塗装)

コスモ工機(株)

| 呼び径     | コスモバルブST型                |                          |                                |                         |         |                            |
|---------|--------------------------|--------------------------|--------------------------------|-------------------------|---------|----------------------------|
|         | フランジ式(ソフトシール弁付)          |                          |                                |                         |         |                            |
|         | 鋳鉄管用<br>STCPFP<br>全周パッキン | 石綿管用<br>STAPFP<br>全周パッキン | 塩ビ・鋼管<br>STVPF・STSPF<br>全周パッキン | 配水ポリ用<br>STPF<br>全周パッキン | 呼び径     | 鋳鉄管用<br>STCF/10M<br>全周パッキン |
| 75X 75  | 175,800                  | 263,970                  | 160,680                        | 239,470 注1              | 250X 75 | 267,340                    |
| 100X 75 | 187,100                  | 190,530                  | 167,410                        | 260,670 注1              | 250X100 | 296,140                    |
| 100X100 | 209,710                  | 317,590                  | 210,470                        | 310,460 注1              | 250X150 | 390,230                    |
| 125X 75 |                          | 205,410                  |                                |                         | 250X200 | 498,850                    |
| 125X100 |                          | 245,650                  |                                |                         | 250X250 | 847,650                    |
| 150X 75 | 206,250                  | 218,010                  | 189,240                        | 301,410 注1              | 300X 75 | 281,000                    |
| 150X100 | 242,360                  | 249,300                  | 222,830                        | 344,020 注1              | 300X100 | 309,710                    |
| 150X150 | 334,400                  | 453,850                  | 311,120                        | 442,190 注1              | 300X150 | 405,130                    |
| 200X 75 | 249,300                  | 255,920                  | 245,500                        | 490,330 注1              | 300X200 | 513,230                    |
| 200X100 | 280,360                  | 291,400                  | 283,610                        | 539,540 注1              | 300X250 | 892,140                    |
| 200X150 | 379,310                  | 394,750                  | 333,210                        | 650,550 注1              | 300X300 | 1,153,680                  |
| 200X200 | 479,030                  | 536,090                  | 480,880                        | 745,630 注1              | 350X 75 | 322,520                    |
| 250X 75 | 265,430 注2               |                          |                                |                         | 350X100 | 355,170                    |
| 250X100 | 286,420 注2               |                          |                                |                         | 350X150 | 446,780                    |
| 250X150 | 371,370 注2               |                          |                                |                         | 350X200 | 554,420                    |
| 250X200 | 494,370 注2               |                          |                                |                         | 350X250 | 922,760                    |
| 300X 75 | 279,130 注2               |                          |                                |                         | 350X300 | 1,660,340                  |
| 300X100 | 305,770 注2               |                          |                                |                         | 400X 75 | 366,570                    |
| 300X150 | 397,020 注2               |                          |                                |                         | 400X100 | 398,450                    |
| 300X200 | 509,990 注2               |                          |                                |                         | 400X150 | 495,620                    |
| 350X 75 | 318,080 注2               |                          |                                |                         | 400X200 | 607,500                    |
| 350X100 | 356,040 注2               |                          |                                |                         | 400X250 | 1,023,570                  |
| 350X150 | 425,330 注2               |                          |                                |                         | 400X300 | 1,175,740                  |
| 350X200 | 564,310 注2               |                          |                                |                         | 450X 75 | 391,630                    |
| 400X 75 | 358,050 注2               |                          |                                |                         | 450X100 | 429,850                    |
| 400X100 | 395,680 注2               |                          |                                |                         | 450X150 | 528,080                    |
| 400X150 | 453,960 注2               |                          |                                |                         | 450X200 | 645,940                    |
| 400X200 | 625,650 注2               |                          |                                |                         | 450X250 | 1,033,870                  |
|         |                          |                          |                                |                         | 450X300 | 1,188,300                  |
|         |                          |                          |                                |                         | 500X 75 | 498,950                    |
|         |                          |                          |                                |                         | 500X100 | 530,910                    |
|         |                          |                          |                                |                         | 500X150 | 626,850                    |
|         |                          |                          |                                |                         | 500X200 | 737,990                    |
|         |                          |                          |                                |                         | 500X250 | 1,196,550                  |
|         |                          |                          |                                |                         | 500X300 | 1,349,820                  |
|         |                          |                          |                                |                         | 600X 75 | 565,140                    |
|         |                          |                          |                                |                         | 600X100 | 597,010                    |
|         |                          |                          |                                |                         | 600X150 | 689,760                    |
|         |                          |                          |                                |                         | 600X200 | 805,160                    |
|         |                          |                          |                                |                         | 600X250 | 1,319,470                  |
|         |                          |                          |                                |                         | 600X300 | 1,515,920                  |

注1 穿孔工事が特殊な為、事前にお問合せ願います

注2 STCDFP-1(三ツ割分岐部パッキン)とSTCF/10M(ニツ割)タイプがございます

# 不断水T字管

## コスモバルブSTソフト型(分岐口径φ75以上) (通水部粉体塗装)

鹿児島市型

コスモ工機(株)

| コスモバルブST型       |                  |                  |                 |                |         |                 |         |           |
|-----------------|------------------|------------------|-----------------|----------------|---------|-----------------|---------|-----------|
| フランジ式(ソフトシール弁付) |                  |                  |                 |                |         |                 |         |           |
| 呼び径             | 鋳鉄管用             | 石綿管用             | 塩ビ・鋼管           | 配水ポリ用          | 呼び径     | 鋳鉄管用            |         |           |
|                 | STCFPF<br>全周パッキン | STAPFP<br>全周パッキン | STVPF<br>全周パッキン | STPF<br>全周パッキン |         | STCF/10M 全周パッキン |         |           |
| 75X 75          | 180,640          | 268,810          | 171,780         | 253,010 注1     | 250X 75 | 316,380         | 450X300 | 1,257,860 |
| 100X 75         | 194,360          | 197,790          | 178,510         | 273,160 注1     | 250X100 | 345,180         | 500X 75 | 572,990   |
| 100X100         | 216,970          | 324,850          | 221,570         | 312,670 注1     | 250X150 | 439,270         | 500X100 | 604,950   |
| 125X 75         |                  | 212,670          |                 |                | 250X200 | 555,530         | 500X150 | 700,890   |
| 125X100         |                  | 252,910          |                 |                | 250X250 | 904,330         | 500X200 | 819,790   |
| 150X 75         | 213,510          | 225,270          | 200,340         | 310,910 注1     | 300X 75 | 330,040         | 500X250 | 1,278,350 |
| 150X100         | 249,620          | 256,560          | 233,930         | 350,730 注1     | 300X100 | 358,750         | 500X300 | 1,431,620 |
| 150X150         | 349,200          | 464,950          | 325,920         | 458,530 注1     | 300X150 | 454,170         | 600X 75 | 652,140   |
| 200X 75         | 260,400          | 267,020          | 256,600         | 503,130 注1     | 300X200 | 562,270         | 600X100 | 684,010   |
| 200X100         | 291,460          | 302,500          | 294,710         | 549,120 注1     | 300X250 | 948,820         | 600X150 | 776,760   |
| 200X150         | 394,110          | 409,550          | 348,010         | 660,510 注1     | 300X300 | 1,210,360       | 600X200 | 899,140   |
| 200X200         | 493,830          | 550,890          | 495,680         | 755,910 注1     | 350X 75 | 380,000         | 600X250 | 1,413,450 |
| 250X 75         | 282,980 注2       |                  |                 |                | 350X100 | 412,650         | 600X300 | 1,609,900 |
| 250X100         | 303,880 注2       |                  |                 |                | 350X150 | 504,260         |         |           |
| 250X150         | 394,650 注2       |                  |                 |                | 350X200 | 615,720         |         |           |
| 250X200         | 517,650 注2       |                  |                 |                | 350X250 | 984,060         |         |           |
| 300X 75         | 296,590 注2       |                  |                 |                | 350X300 | 1,721,640       |         |           |
| 300X100         | 323,230 注2       |                  |                 |                | 400X 75 | 432,250         |         |           |
| 300X150         | 420,300 注2       |                  |                 |                | 400X100 | 464,130         |         |           |
| 300X200         | 533,270 注2       |                  |                 |                | 400X150 | 561,300         |         |           |
| 350X 75         | 335,540 注2       |                  |                 |                | 400X200 | 677,060         |         |           |
| 350X100         | 373,500 注2       |                  |                 |                | 400X250 | 1,093,130       |         |           |
| 350X150         | 448,610 注2       |                  |                 |                | 400X300 | 1,245,300       |         |           |
| 350X200         | 587,590 注2       |                  |                 |                | 450X 75 | 457,310         |         |           |
| 400X 75         | 375,510 注2       |                  |                 |                | 450X100 | 495,530         |         |           |
| 400X100         | 413,140 注2       |                  |                 |                | 450X150 | 593,760         |         |           |
| 400X150         | 477,240 注2       |                  |                 |                | 450X200 | 715,500         |         |           |
| 400X200         | 648,930 注2       |                  |                 |                | 450X250 | 1,103,430       |         |           |

注1 穿孔工事が特殊な為、事前にお問い合わせ願います

注2 STCDFP-1(三ツ割分岐部パッキン)とSTCF/10M(ニツ割)タイプがございます

※下記は鋳鉄管用の寸法になります

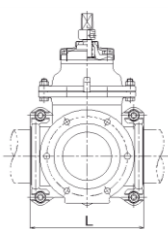
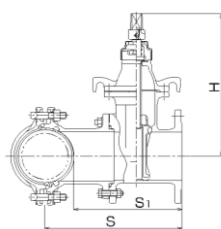

| 呼び径     | S     | S1  | L   | H   | T頭ボルト・ナット |
|---------|-------|-----|-----|-----|-----------|
| 75x 75  | 296.5 |     | 209 |     | 4-M16x85  |
| 100x 75 | 309.0 |     | 264 |     | 6-M16x85  |
| 125x 75 | 321.5 | 247 | 264 | 315 | 6-M16x85  |
| 150x 75 | 335.0 |     | 268 |     | 6-M16x85  |
| 200x 75 | 360.5 |     | 268 |     | 6-M20x90  |
| 100x100 | 315.0 | 253 | 264 |     | 6-M16x85  |
| 125x100 | 327.5 | 253 | 264 |     | 6-M16x85  |
| 150x100 | 346.0 | 258 | 268 | 355 | 6-M16x85  |
| 200x100 | 381.5 | 268 | 268 |     | 6-M20x90  |
| 150x150 | 420.0 | 332 | 348 | 446 | 6-M20x90  |
| 200x150 | 445.5 | 332 | 398 | 445 | 8-M20x90  |
| 200x200 | 444.5 | 331 | 398 | 540 | 8-M20x90  |



**不断水T字管**  
**ヤノT字管S型(分岐口径φ40・50)**  
 シーバー弁付不断水分岐用割T字管  
 (通水部粉体塗装)

大成機工株

| 呼び径    | 内ねじ式・外ねじ式      |                |                |                | フランジ式      |            |            |            |
|--------|----------------|----------------|----------------|----------------|------------|------------|------------|------------|
|        | 鋳鉄管用           | 石綿管用           | 塩ビ・鋼管          | 配水ポリ用          | 鋳鉄管用       | 石綿管用       | 塩ビ・鋼管      | 配水ポリ用      |
|        | TY-105(SS・SUN) | TY-105(SS・SUN) | TY-105(SS・SUN) | TY-105(SS・SUN) | TY-105(SF) | TY-105(SF) | TY-105(SF) | TY-105(SF) |
| 50X40  |                |                |                | 75,810 注1      |            |            |            |            |
| 50X50  | 53,140         |                | 53,140         | 80,750 注1      | 59,630     |            | 59,630     | 81,970 注1  |
| 75X40  | 51,580         | 51,580         | 51,580         | 78,450 注1      |            |            |            |            |
| 75X50  | 54,790         | 54,790         | 54,790         | 84,350 注1      | 60,620     | 60,620     | 60,620     | 87,620 注1  |
| 100X40 | 56,100         | 56,100         | 56,100         | 85,000 注1      |            |            |            |            |
| 100X50 | 59,200         | 59,200         | 59,200         | 90,260 注1      | 65,240     | 65,240     | 65,240     | 99,570 注1  |
| 125X40 | 61,300         | 61,300         |                |                |            |            |            |            |
| 125X50 | 64,440         | 64,440         |                |                | 70,170     | 70,170     |            |            |
| 150X40 | 65,480         | 65,480         | 65,480         | 99,960 注1      |            |            |            |            |
| 150X50 | 68,810         | 68,810         | 68,810         | 104,810 注1     | 74,790     | 74,790     | 74,790     | 113,190 注1 |
| 200X40 | 84,720         | 85,930         | 84,720         | 126,950 注1     |            |            |            |            |
| 200X50 | 87,980         | 88,880         | 87,890         | 130,550 注1     | 94,500     | 94,910     | 94,500     | 141,770 注1 |
| 250X40 | 97,940         | 209,640        | 97,940         |                |            |            |            |            |
| 250X50 | 101,070        | 212,860        | 101,070        |                | 107,100    | 219,240    | 107,100    |            |
| 300X40 | 110,780        | 227,320        |                |                |            |            |            |            |
| 300X50 | 111,360        | 230,820        |                |                | 117,340    | 235,650    |            |            |
| 350X40 | 117,340        |                |                |                |            |            |            |            |
| 350X50 | 120,420        |                |                |                | 126,210    |            |            |            |
| 400X40 | 168,600        |                |                |                |            |            |            |            |
| 400X50 | 173,020        |                |                |                | 178,230    |            |            |            |
| 450X40 | 383,850        |                |                |                |            |            |            |            |
| 450X50 | 388,590        |                |                |                | 394,210    |            |            |            |
| 500X40 | 494,910        |                |                |                |            |            |            |            |
| 500X50 | 499,630        |                |                |                | 505,250    |            |            |            |
|        |                |                |                |                |            |            |            |            |
|        |                |                |                |                |            |            |            |            |
|        |                |                |                |                |            |            |            |            |
|        |                |                |                |                |            |            |            |            |

\* 50X50は二ツ割です

\* 鋳鉄管用50x50は塩ビ管・鋼管用と兼用です

注1 穿孔工事が特殊な為、事前にお問合せ願います

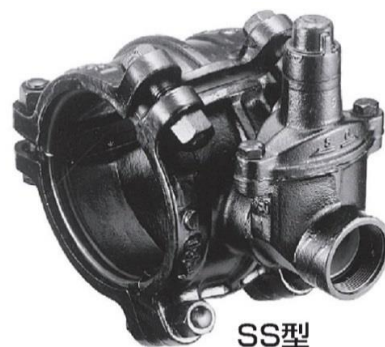

## 不断水T字管

### ヤノT字管S型(分岐口径φ40・50)

シーバー弁付不断水分岐用割T字管  
(通水部粉体塗装)

鹿児島市型  
SUSホルトナット使用

大成機工(株)

| 呼び径    | 内ねじ式・外ねじ式      |                |                |                | フランジ式      |            |            |            |
|--------|----------------|----------------|----------------|----------------|------------|------------|------------|------------|
|        | 鋳鉄管用           | 石綿管用           | 塩ビ・鋼管          | 配水ポリ用          | 鋳鉄管用       | 石綿管用       | 塩ビ・鋼管      | 配水ポリ用      |
|        | TY-105(SS・SUN) | TY-105(SS・SUN) | TY-105(SS・SUN) | TY-105(SS・SUN) | TY-105(SF) | TY-105(SF) | TY-105(SF) | TY-105(SF) |
| 50X40  |                |                |                | 75,810         |            |            |            |            |
| 50X50  | 57,420         |                | 57,420         | 80,750         | 63,910     |            | 63,910     | 81,970     |
| 75X40  | 58,060         | 58,060         | 58,060         | 78,450         |            |            |            |            |
| 75X50  | 61,270         | 61,270         | 61,270         | 84,350         | 67,100     | 67,100     | 67,100     | 87,620     |
| 100X40 | 62,580         | 62,580         | 62,580         | 85,000         |            |            |            |            |
| 100X50 | 65,680         | 65,680         | 65,680         | 90,260         | 71,720     | 71,720     | 71,720     | 99,570     |
| 125X40 | 67,780         | 67,780         |                |                |            |            |            |            |
| 125X50 | 70,920         | 70,920         |                |                | 76,650     | 76,650     |            |            |
| 150X40 | 77,180         | 77,180         | 77,180         | 99,960         |            |            |            |            |
| 150X50 | 80,510         | 80,510         | 80,510         | 104,810        | 86,490     | 86,490     | 86,490     | 113,190    |
| 200X40 | 96,900         | 98,290         | 96,900         | 126,950        |            |            |            |            |
| 200X50 | 100,070        | 101,240        | 100,070        | 130,550        | 106,680    | 107,270    | 106,680    | 141,770    |
| 250X40 | 110,300        | 234,360        | 110,300        |                |            |            |            |            |
| 250X50 | 113,430        | 237,580        | 113,430        |                | 119,460    | 243,960    | 119,460    |            |
| 300X40 | 123,140        | 252,040        |                |                |            |            |            |            |
| 300X50 | 123,720        | 255,540        |                |                | 129,700    | 260,370    |            |            |
| 350X40 | 129,700        |                |                |                |            |            |            |            |
| 350X50 | 132,780        |                |                |                | 138,570    |            |            |            |
| 400X40 | 192,240        |                |                |                |            |            |            |            |
| 400X50 | 196,660        |                |                |                | 201,870    |            |            |            |
| 450X40 | 412,050        |                |                |                |            |            |            |            |
| 450X50 | 416,790        |                |                |                | 422,410    |            |            |            |
| 500X40 | 529,590        |                |                |                |            |            |            |            |
| 500X50 | 534,310        |                |                |                | 539,930    |            |            |            |
| 600X40 |                |                |                |                |            |            |            |            |
| 600X50 |                |                |                |                |            |            |            |            |
| 700X40 |                |                |                |                |            |            |            |            |
| 700X50 |                |                |                |                |            |            |            |            |

- \* 50X50は二ツ割です
- \* 鋳鉄管用50x50は塩ビ管・鋼管用と兼用です
- \* 鋳鉄管用は二ツ割です

不断水T字管  
ヤノT字管V型(分岐口径φ75以上)  
(通水部粉体塗装)

大成機工(株)

| 呼び径     | ヤノT字管V型  |         |         |            |         |
|---------|--|---------|---------|------------|---------|
|         | フランジ式(ソフトシール弁付)  |         |         |            |         |
|         | 鋳鉄管用   | 石綿管用    | 鋼管用     | 塩ビ用        | 配水ポリ用   |
|         | TN-65VS  | TN-65VS | TN-65VS | TN-65VS    | TN-01VS |
| 75X 75  | 255,670  | 293,670 | 255,670 | 163,500    | 241,570 |
| 100X 75 | 181,570  | 182,600 | 181,570 | 170,400    | 260,300 |
| 100X100 | 319,330  | 352,800 | 319,330 | 214,020    | 307,950 |
| 125X 75 | 192,130  | 197,340 | 192,130 |            |         |
| 150X 75 | 202,570  | 204,920 | 202,570 | 192,600    | 304,590 |
| 150X100 | 245,970  | 250,880 | 245,970 | 226,820    | 346,070 |
| 150X150 | 437,870  | 503,120 | 437,870 | 316,330    | 437,480 |
| 200X 75 | 249,850  | 255,940 | 249,850 | 249,850 注1 | 487,210 |
| 200X100 | 288,720  | 294,640 | 288,720 | 288,720 注1 | 536,100 |
| 200X150 | 376,270  | 380,800 | 376,270 | 337,480    | 646,400 |
| 200X200 | 647,960  | 721,560 | 647,960 | 489,420    | 747,820 |
| 250X 75 | 263,150  | 271,680 | 263,150 |            |         |
| 250X100 | 293,510  | 301,710 | 293,510 |            |         |
| 250X150 | 380,630  | 384,880 | 380,630 |            |         |
| 250X200 | 755,720  | 850,170 | 755,720 |            |         |
| 300X 75 | 277,270  | 301,860 | 277,270 |            |         |
| 300X100 | 307,570  | 334,220 | 307,570 |            |         |
| 300X150 | 388,430  | 407,610 | 388,430 |            |         |
| 300X200 | 503,430  | 545,150 | 503,430 |            |         |
| 350X 75 | 326,810  |         |         |            |         |
| 350X100 | 358,900  |         |         |            |         |
| 350X150 | 435,340  |         |         |            |         |
| 350X200 | 546,570  |         |         |            |         |
| 400X 75 | 351,040  |         |         |            |         |
| 400X100 | 383,820  |         |         |            |         |
| 400X150 | 469,190  |         |         |            |         |
| 400X200 | 602,200  |         |         |            |         |
| 450X 75 | 369,660  |         |         |            |         |
| 450X100 | 397,290  |         |         |            |         |
| 450X150 | 488,460  |         |         |            |         |
| 450X200 | 642,440  |         |         |            |         |
| 500X 75 | 451,750  |         |         |            |         |
| 500X100 | 516,180  |         |         |            |         |
| 500X150 | 573,190  |         |         |            |         |
| 500X200 | 738,940  |         |         |            |         |
| 600X 75 | 560,550  |         |         |            |         |
| 600X100 | 587,770  |         |         |            |         |
| 600X150 | 638,560  |         |         |            |         |
| 600X200 | 809,280  |         |         |            |         |
|         | * 分岐φ75～200はキーキャップ付で仕切弁として使用可<br>* 分岐φ300はキーキャップ無しの不断水専用バルブです<br>* 塩ビ管用は二ツ割ですが、注1は三ツ割となります |         |         |            |         |

## 不断水T字管

### ヤノT字管V型(分岐口径φ75以上) (通水部粉体塗装)

鹿児島市型  
SUSボルトナット使用

大成機工(株)

| 呼び径     | ヤノT字管V型         |         |         |         |         |
|---------|-----------------|---------|---------|---------|---------|
|         | フランジ式(ソフトシール弁付) |         |         |         |         |
|         | 鋳鉄管用            | 石綿管用    | 鋼管用     | 塩ビ用     | 配水ポリ用   |
|         | TN-65VS         | TN-65VS | TN-65VS | TN-65VS | TN-01VS |
| 75X 75  | 281,030         | 319,030 | 281,030 | 163,500 | 241,570 |
| 100X 75 | 195,570         | 196,600 | 195,570 | 170,400 | 260,300 |
| 100X100 | 343,690         | 377,160 | 343,690 | 214,020 | 307,950 |
| 125X 75 | 206,650         | 211,860 | 206,650 |         |         |
| 150X 75 | 226,210         | 228,560 | 226,210 | 192,600 | 304,590 |
| 150X100 | 269,610         | 274,520 | 269,610 | 226,820 | 346,070 |
| 150X150 | 462,230         | 527,480 | 462,230 | 316,330 | 437,480 |
| 200X 75 | 274,570         | 280,660 | 274,570 | 274,570 | 注1      |
| 200X100 | 313,440         | 319,360 | 313,440 | 313,440 | 注1      |
| 200X150 | 400,990         | 405,520 | 400,990 | 337,480 |         |
| 200X200 | 684,680         | 758,280 | 684,680 | 489,420 |         |
| 250X 75 | 287,870         | 296,400 | 287,870 |         |         |
| 250X100 | 318,230         | 326,430 | 318,230 |         |         |
| 250X150 | 405,350         | 409,600 | 405,350 |         |         |
| 250X200 | 792,440         | 886,890 | 792,440 |         |         |
| 300X 75 | 301,990         | 326,580 | 301,990 |         |         |
| 300X100 | 332,290         | 358,940 | 332,290 |         |         |
| 300X150 | 413,150         | 432,330 | 413,150 |         |         |
| 300X200 | 528,150         | 569,870 | 528,150 |         |         |
| 350X 75 | 355,010         |         |         |         |         |
| 350X100 | 387,100         |         |         |         |         |
| 350X150 | 463,540         |         |         |         |         |
| 350X200 | 574,770         |         |         |         |         |
| 400X 75 | 379,240         |         |         |         |         |
| 400X100 | 412,020         |         |         |         |         |
| 400X150 | 497,390         |         |         |         |         |
| 400X200 | 630,400         |         |         |         |         |

\* 分岐φ75~200はキーキャップ付で仕切弁として使用可  
 \* 分岐φ300はキーキャップ無しの不断水専用バルブです  
 \* 塩ビ管用は二ツ割ですが、注1は三ツ割となります



ヤノT字管V型



同口径ヤノT字管V型